

## PFR3

**NEW**

| Part Number | Dash Size | Hose ID Size |      | B OD (mm) | L Length (mm) | Weight Each (lbs.) |
|-------------|-----------|--------------|------|-----------|---------------|--------------------|
|             |           | (in.)        | (mm) |           |               |                    |
| PFR3-04     | -04       | 1/4          | 6.4  | 14.75     | 28.9          | 0.03               |
| PFR3-05     | 05        | 5/16         | 7.9  | 17.4      | 28.8          | 0.04               |
| PFR3-06     | -06       | 3/8          | 9.5  | 19        | 28.8          | 0.04               |
| PFR3-08     | -08       | 1/2          | 12.7 | 23.7      | 36.3          | 0.06               |

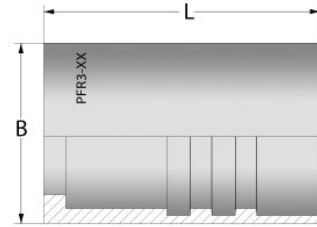

## AFX

**NEW**

| Part Number | Dash Size | Hose ID Size |      | B OD (mm) | L Length (mm) | Weight Each (lbs.) |
|-------------|-----------|--------------|------|-----------|---------------|--------------------|
|             |           | (in.)        | (mm) |           |               |                    |
| AFX-03      | 03        | 3/16         | 4.8  | 21        | 21.5          | 0.05               |
| AFX-04      | 04        | 1/4          | 6.4  | 23        | 24.7          | 0.07               |
| AFX-05      | 05        | 5/16         | 7.9  | 25        | 24.7          | 0.08               |
| AFX-06      | 06        | 3/8          | 9.5  | 27        | 29.7          | 0.10               |
| AFX-08      | 08        | 1/2          | 12.7 | 30        | 30.5          | 0.11               |
| AFX-10      | 10        | 5/8          | 15.9 | 34        | 35.5          | 0.15               |
| AFX-12      | 12        | 3/4          | 19.0 | 38        | 36.0          | 0.17               |
| AFX-16      | 16        | 1            | 25.4 | 48        | 42.5          | 0.28               |

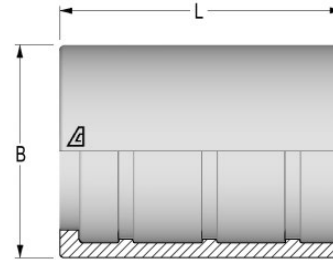

## Universal Ferrules

For SAE 100R7, 100R8, 100R18 & ANSI 92.2 Hoses (Steel)

## PFR/PFR7

| Part Number | Dash Size | Hose ID Size |       | B OD (mm) | L Length (mm) | Weight Each (lbs.) |
|-------------|-----------|--------------|-------|-----------|---------------|--------------------|
|             |           | (in.)        | (mm)  |           |               |                    |
| PFR-03      | 03        | 3/16         | 4.7   | 14.9      | 24.0          | 0.03               |
| PFR-04      | 04        | 1/4          | 6.4   | 17.0      | 29.0          | 0.04               |
| PFR7-05*    | 05        | 5/16         | 7.9   | 19.0      | 29.0          | 0.04               |
| PFR-06      | 06        | 3/8          | 9.5   | 21.0      | 31.0          | 0.05               |
| PFR-08      | 08        | 1/2          | 12.7  | 25.4      | 36.0          | 0.06               |
| PFR-12      | 12        | 3/4          | 19.05 | 31.8      | 45.2          | 0.11               |

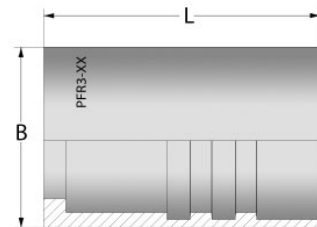

\* PFR7-05 ferrules are to be used only with SAE 100R7 hoses!

Kuriyama stocks a variety of fittings designed for use with all of our Piranhaflex™ SAE 100R7, 100R8, 100R18 and ANSI 92.2 hoses. For more information contact your nearest Kuriyama warehouse location. Please refer to our latest Kuriyama Hydraulic Connections Catalog for a complete list of available two-piece fittings.

Because we continually examine ways to improve our products, we reserve the right to alter specifications or discontinue products without prior notice.